

30 312 DC0 K7 FOOT CONTROL ELECTRONIC SINGLE-LEVER SINK MIXER 1/2"

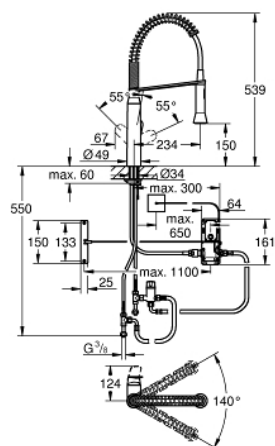

PRODUCT DESCRIPTION

- Colour: supersteel
- medium spout
- Foot control: activation of water via contact with sensor
- battery supply 6 V lithium-battery, type CR-P2
- CE approved
- solenoid valve
- fixing value
- safety stop after 60 sec.(factory set)
- type of protection IP 44
- GROHE SilkMove 35 mm ceramic cartridge
- professional spray
- diverter: mousseur/spray jet
- automatic return to mousseur
- adjustable flow rate limiter
- swivel tubular spout
- swivel area 360°
- protected against backflow
- flexible connection hoses
- rapid installation system



30 312 DC0 K7 FOOT CONTROL ELECTRONIC SINGLE-LEVER SINK MIXER 1/2"

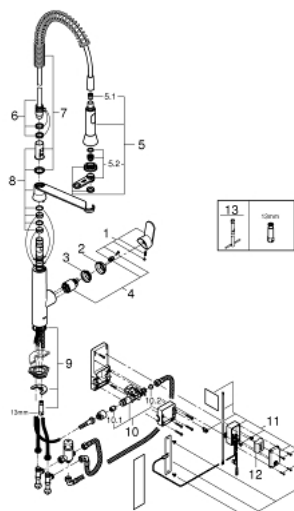

SPARE PARTS

- 1: Lever (Spare part-nr. 46927DC0)
 - 2: Cap (Spare part-nr. 46116DC0)
 - 3: Screw coupling (Spare part-nr. 46460000)
 - 4: Cartridge (Spare part-nr. 46374000)
 - 5: Hand shower (Spare part-nr. 46731DC0)
 - 5.1: Non-return valve (Spare part-nr. 08565000)
 - 5.2: Mousseur (Spare part-nr. 46711000)
 - 6: Shower hose (Spare part-nr. 46871DC0)
 - 7: Spring (Spare part-nr. 46873SD0)
 - 8: Holder pull out spray (Spare part-nr. 46734DC0)
 - 9: Shank mounting kit (Spare part-nr. 46671000)
 - 10: Solenoid valve (Spare part-nr. 48213000)
 - 10.1: Non-return valve (Spare part-nr. 08565000)
 - 10.2: Dirt strainer (Spare part-nr. 42395000)
 - 11: Control unit (Spare part-nr. 48304000)
 - 12: Battery (Spare part-nr. 42886000)
 - 13: Mounting wrench (Spare part-nr. 19017000)*
- * Optional accessories