

## 29 407 DL0 ATRIO 5-HOLE BATH/SHOWER COMBINATION

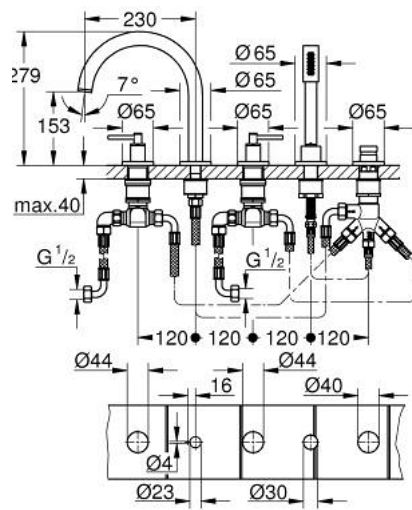

### PRODUCT DESCRIPTION

- Colour: brushed warm sunset
- ceramic headparts 1/2", 90°
- GROHE LongLife finish
- consisting of:
  - pre-assembled spout fixing
  - with lever handles
  - bath spout with mousseur and diverter bath/shower
  - hand shower Rainshower Aqua Stick 6.5 l/min
  - shower hose 2000 mm
  - flexible connection hoses
  - connection for shower hose
  - protected against backflow
  - can be used with 29 037
  - maximum flow rate (at 3 bar): 7.6 l/min (hand shower)
  - Two different sets of caps included. One set with "H" and "C" marking, one set without marking

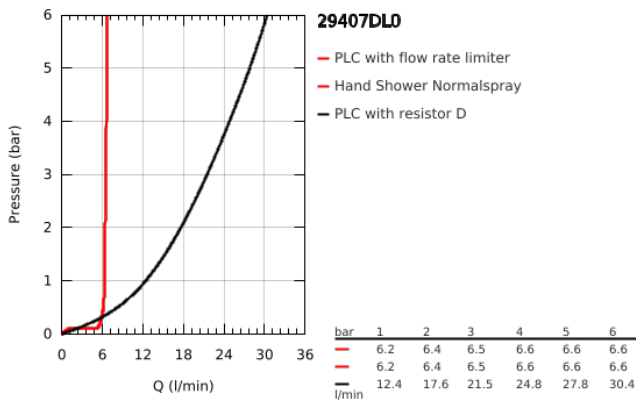

## 29 407 DL0 ATRIO 5-HOLE BATH/SHOWER COMBINATION

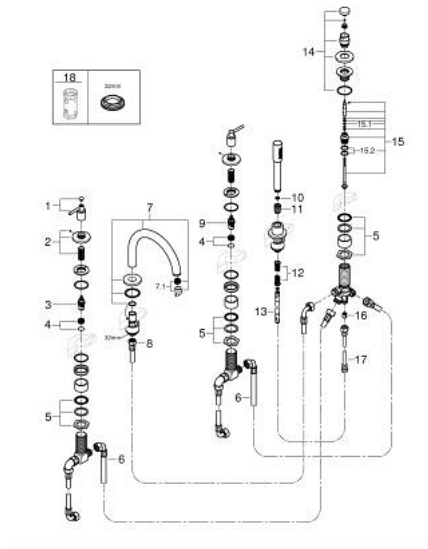

### SPARE PARTS

- 1: Lever handle bath (Spare part-nr. 14218DL0)
  - 2: Escutcheon (Spare part-nr. 101351DL00)
  - 3: Ceramic headpart 3/4" 180° (Spare part-nr. 45888000)
  - 4: Valve seat 3/4" (Spare part-nr. 45345000)
  - 5: Repl. kit for shank fastening (Spare part-nr. 45444000)
  - 6: Tube (Spare part-nr. 48019000)
  - 7: Outlet (Spare part-nr. 101350DL00)
  - 7.1: Mousseur (Spare part-nr. 13926000)
  - 8: Tube (Spare part-nr. 48018000)
  - 9: Ceramic headpart 3/4" 180° (Spare part-nr. 45887000)
  - 10: Dirt strainer (Spare part-nr. 0700200M)
  - 11: Cone nut (Spare part-nr. 08864DL0)
  - 12: Spring (Spare part-nr. 00869000)
  - 13: Metal hose (Spare part-nr. 28146000)
  - 14: Diverter knob (Spare part-nr. 48411DL0)
  - 15: Diverter (Spare part-nr. 45443000)
  - 15.1: Sealing washer Ø6 x Ø2 (Spare part-nr. 0128300M)
  - 15.2: Sealing washer (Spare part-nr. 0120500M)
  - 16: Non-return valve (Spare part-nr. 08565000)
  - 17: Tube (Spare part-nr. 07300000)
  - 18: Socket Spanner (Spare part-nr. 19332000)\*
- \* Optional accessories