

## 19 809 001 **COSTA L CONCEALED VALVE EXPOSED PART**



### PRODUCT DESCRIPTION

- Colour: chrome
- final installation for
  - 35 028 000
  - for concealed valves 29 800 1/2", 29 802 3/4", 29 805 1"
  - installation depth infinitely adjustable 20-80 mm
  - escutcheon with wall sealing
  - screwable
  - metal handle
  - heat insulated
  - marking: red
  - GROHE Long-Life finish



## 19 809 001 **COSTA L CONCEALED VALVE EXPOSED PART**

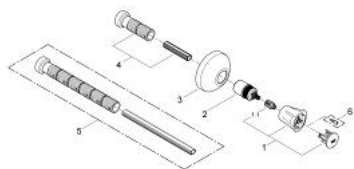

### **SPARE PARTS**

- 1: Handle (Spare part-nr. 45994000)
  - 1.1: Snap insert (Spare part-nr. 0538600M)
  - 2: Extension for spindle (Spare part-nr. 45204000)
  - 3: Escutcheon (Spare part-nr. 45219000)
  - 4: Extension-set, 80 mm (Spare part-nr. 45202000)
  - 5: Extension-set 200 mm (Spare part-nr. 45203000)\*
  - 6: Screw for Costa/Avina products (Spare part-nr. 48013000)\*
- \* Optional accessories